



# StormBasin

Modular Stormwater Filtration System

## Maintenance Guide

For

Nassau County Item 504A – Type “A”  
Catch Basin Insert - Filter Type  
Combination Inlet

### Caution

Do not step, stand, sit or in anyway use the StormBasin device to support your weight during the maintenance procedure.

### Caution

StormBasin units maybe installed into street level drain inlets. The StormBasin should be maintained by trained individuals who are familiar with all Traffic safety regulations.

## Maintenance Guide

### Pre-installation Cleaning

The StormBasin like any other storm water remediation device requires maintenance to remain efficient as a storm water filter. Fabco Industries highly recommends inspecting the perspective catch basin storm sewer before installing a StormBasin unit and thoroughly cleaning it if necessary.



### Cleaning Frequency

After installation the StormBasin requires periodic cleaning. There are no hard and fast rules in this regard. Small units and installation sites with higher than expected sediment loads or areas with significant trees and foliage require more maintenance. In general, Fabco Industries recommends cleaning out the unit(s) a minimum twice per year by removing the debris, sand and silt.

### Cleaning out the StormBasin: Combination style drain inlets

<p>Do not lift or remove the StormBasin from the grated inlet during cleaning. Be sure to follow proper road safety rules &amp; regulations when working in the street.</p> <p>Begin by removing the grate from the inlet. CAUTION: Grates are extremely heavy. Some type of lifting mechanism is highly recommended.</p> <p>Place it carefully on the ground away from the work area.</p>	
<p>With the grate removed the StormBasin is available for cleaning. Do not step, stand, sit or in anyway use the StormBasin to support your weight. Be sure to follow all Safety and Traffic protocols.</p> <p>Remove the sediment and debris from the basin. This can be done manually or with a vacuum device. Be sure you are wearing gloves, safety glasses and that traffic safety procedures are observed.</p>	
<p>With the debris and sediment removed the filter cartridge(s) will be visible at the bottom of the unit. We suggest removing the cartridge(s) from the StormBasin and removing any loose debris, sediment, trash from the blue foam pre-filter. (See Removing the filter Cartridge). Cartridge replacement is recommended annually.</p>	
<p>With the StormBasin and cartridges cleaned and re-installed the maintenance process is complete. Re-install the drain grate to complete the job.</p>	

## Maintenance Guide

### Selecting, Removing and Installing the StormBasin Cartridges

The Fabco filter cartridges used in the StormBasin product are designed primarily to capture: floating materials, sediments and suspended solids and emulsified products such as hydrocarbon compounds, dissolved heavy metals, nutrients (P&N) and pathogens (bacteria). Before ordering your cartridges make sure you select the correct type. Each cartridge type can be identified by a colored “Ring” located at the top of the cartridge.

### Selecting the right cartridge(s)

Part Number	Effectiveness	Ring color code
9718-1	<b>Standard Cartridge</b> Good All-purpose cartridge for common surface runoff that may contain a little bit of everything.	Red
9718-2	<b>Pathogens Cartridge</b> 2x's more pathogen treatment Vs. Std Cartridge. Use near sensitive water ways to keep beaches and shell fishing areas open.	Yellow
9718-3	<b>HV Hydrocarbon Cartridge</b> 25% more hydrocarbon filter media Vs Std cartridge. Excellent for vehicle or maintenance related applications.	Blue
9718-4	<b>HV Metals Cartridge</b> Uses unique FABLITE filter media for HV metals. Suggested for industrial usage where persistent HV metals have been identified in surface runoff	Grey
9718-5	<b>Standard short Cartridge</b> Reduced height version of std Cart.	Mint
9718-6	<b>Nutrients Cartridge</b> Uses proprietary FABPHOS media for nutrients. Highly effective on the critical dissolved Ortho-Phosphates. Helps reduce algae blooms keeping the water clean and healthy.	Green

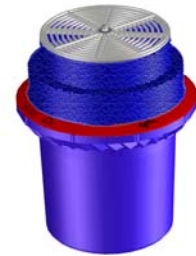
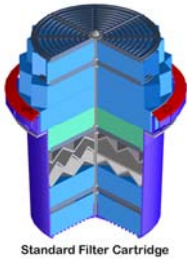

## Maintenance Guide

Referring to the pollutant concentrations stated in the NYS stormwater design manual, the standard cartridge should be expected to last a minimum of 1 year. Fabco's special short cartridge should be replaced twice per year.

### Removing the Filter Cartridge(s)

With all debris removed from the StormBasin the filter cartridge(s) will be exposed at the bottom. To remove the cartridge(s) reach down into the basin and firmly grasp the plastic outer rim of the cartridge body just below the foam. Twist the cartridge body Counter-Clock-wise about  $\frac{1}{4}$  turn until it stops. Lift the cartridge straight up to remove.



### Installing new Filter Cartridge(s)

The StormBasin filter cartridge(s) install through a hole in the bottom of the collection basin. The hole has four (4) slots that accept 4 tabs molded into the underside of the cartridge body.

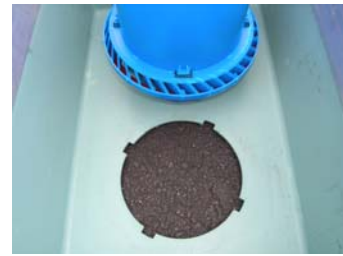

Insert the StormBasin cartridge down through the hole in the base of the unit. The colored ring on the cartridge should be facing upwards. Push the cartridge all the way through the hole until it rests on the bottom. Slowly turn the cartridge in a Clock-wise direction until the Tabs align with the slots and the cartridge body drops about  $\frac{1}{4}$ ' further down.



Once the Tabs fall through the slots, continue turning firmly in a Clock-wise direction until the Tabs contact the STOPS. The Cartridge is now installed.

